

## SBI Linear Rail Series Miniature Series: SBM, SBML

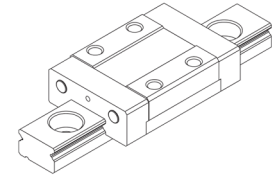

**SBM**  
Standard Miniature

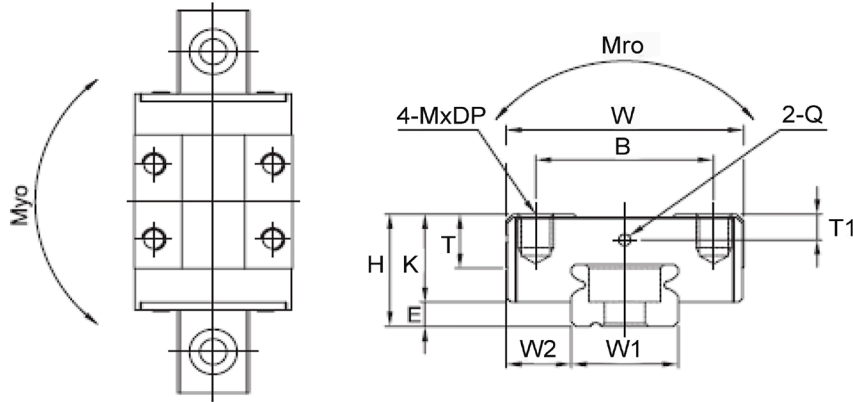
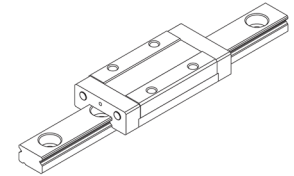

**SBML**  
Block Length is modified to increase load capacity

Model	Mounting dimension				Block dimensions									
	H	W	L	E	Mounting tap hole				L1	T±1	K	Grease fitting		
					B	J	M	DP				T1	Q	
SBM 07	8	17	22.8	1.5	12	8	M2	2.5	13.4	3.3	6.5	1.6	ø1	
SBML 07	8	17	32.4	1.5	12	13	M2	2.5	23	3.3	6.5	1.6	ø1	
SBM 09	10	20	30.1	2	15	10	M3	3	19.3	4.5	7.8	2.3	ø1	
SBML 09	10	20	39.6	2	15	16	M3	3	28.8	4.5	7.8	2.3	ø1	
SBM 12	13	27	34.6	3	20	15	M3	3.5	21	5.5	10	2.8	ø1	
SBML 12	13	27	44.3	3	20	20	M3	3.5	30.7	5.5	10	2.8	ø1	
SBM 15	16	32	43	4	25	20	M3	4	25.4	6.5	12	3.1	ø1	
SBML 15	16	32	58.8	4	25	25	M3	4	41.2	6.5	12	3.1	ø1	

C (Basic dynamic load rating), Co (Basic static load rating)

# LINEAR RAIL SYSTEM

Available for Quick Delivery  
Miniature Series: SBM, SBML

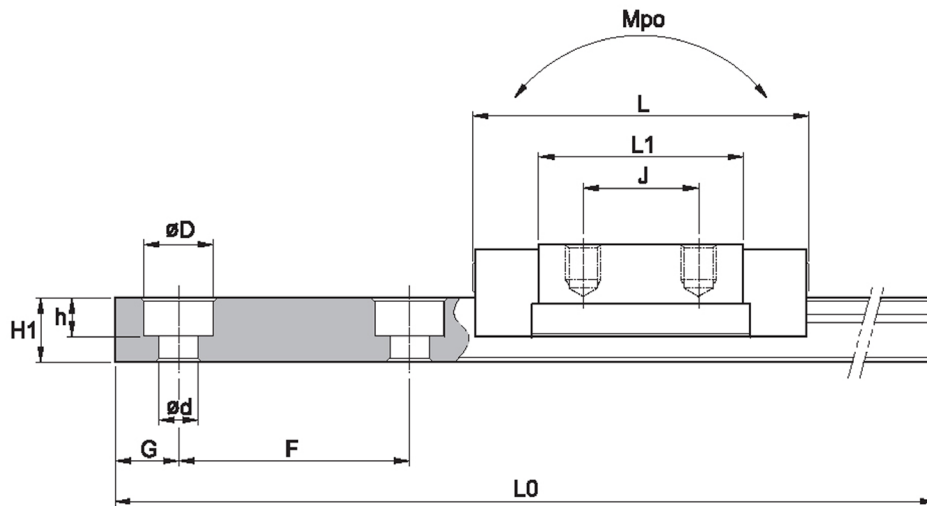

Model	Rail dimensions									Basic load rating (kN)		Permissible static moment (kN·m)			Mass	
	W1	W2	H1	F	Bolt hole			G	Max Rail Length L0	C	Co	Mro	Mpo	Myo	Block (kg)	Rail (kg/m)
	d	D	h		d	D	h									
SBM 07	7	5	4.7	15	2.6	4.3	2.3	5	490	0.88	1.37	4.9	2.94	2.94	0.006	0.23
SBML 07	7	5	4.7	15	2.6	4.3	2.3	5	490	1.59	2.5	8.82	7.84	7.84	0.015	0.23
SBM 09	9	6	5.5	20	4	6	3.3	7.5	1195	1.42	2.9	10.39	5.1	5.1	0.013	0.32
SBML 09	9	6	5.5	20	4	6	3.3	7.5	1195	2.59	3.92	18.33	17.54	14.54	0.023	0.32
SBM 12	12	8	7.5	25	4	6	4.5	10	1195	2.46	3.64	14.7	8.04	8.72	0.029	0.59
SBML 12	12	8	7.5	25	4	6	4.5	10	1195	4.21	6.56	26.66	24.01	26.07	0.043	0.59
SBM 15	15	9	9.5	40	4	6	4.5	15	1190	4.02	5.97	37.24	16.46	17.93	0.52	0.99
SBML 15	15	9	9.5	40	4	6	4.5	15	1190	7.15	10.68	53.02	49.3	53.51	0.079	0.99